

DC Motors

D2431-071200

Issue 06:CN5129

Unit: mm

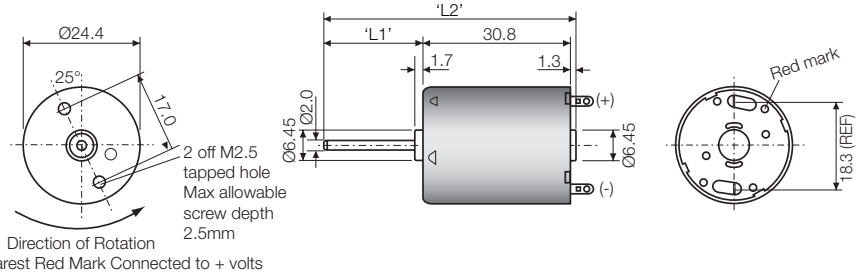

Model Number	Performance									
	Volts V	No Load		Maximum Efficiency				Stall		Max Power W
		Speed rpm	Current A	Speed rpm	Current A	Torque mNm	Output W	Torque mNm	Current A	
D2431-071200	24	3877	0.02	3009	0.05	1.9	0.6	8.3	0.2	0.8
	12	1900	0.01	1392	0.03	1.1	0.2	4.0	0.1	0.2

Performance characteristics and general specification are from calculated data.

Characteristics

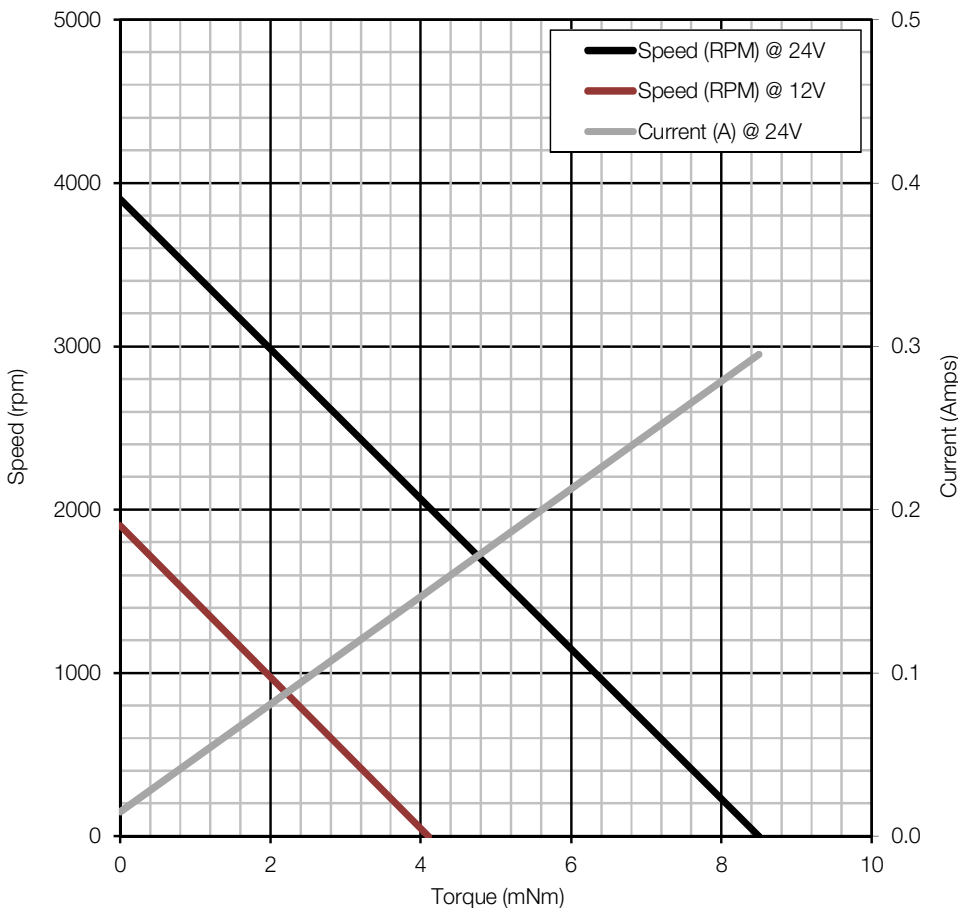

General Specification

Bearings	Sintered
Brushes	Carbon
Rotation	Bi-directional
Number of poles	3
Operating voltage	12 V to 30 V
Nominal resistance	124.5 Ω
Nominal inductance	106.7 mH
Typical detent torque	1 mNm
Suppression	Internal ring varistor
Weight (D2431-071200)	47 g
Shaft length options 'L1','L2'	
D2431-071200	20.5mm, 52.6mm
D2431-071200S	11.5mm, 43.6mm

Contact:

www.rotalink.com
info@rotalink.com
 T: +44 (0)1460 72000

Rotalink Limited
 Cropmead, Crewkerne
 Somerset TA18 7HQ, UK

www.rotalink.com