

DC Motors

D2838-16120

Issue 08:CN3448

Unit: mm

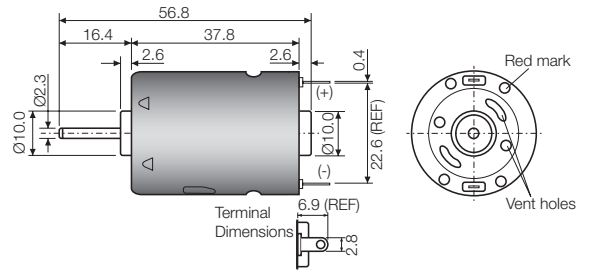
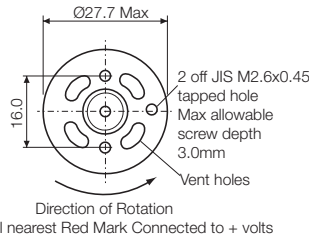

Model Number	Performance									
	Volts V	No Load		Maximum Efficiency				Stall		Max Power W
		Speed rpm	Current A	Speed rpm	Current A	Torque mNm	Output W	Torque mNm	Current A	
D2838-16120	24	11200	0.11	9900	0.54	7.8	7.8	47.0	2.6	13.8
	18	8400	0.10	6916	0.40	6.2	4.5	35.3	2.0	7.8
	12	5600	0.09	4502	0.33	4.6	2.2	23.5	1.3	3.4

Performance characteristics and general specification are from calculated data.

Characteristics

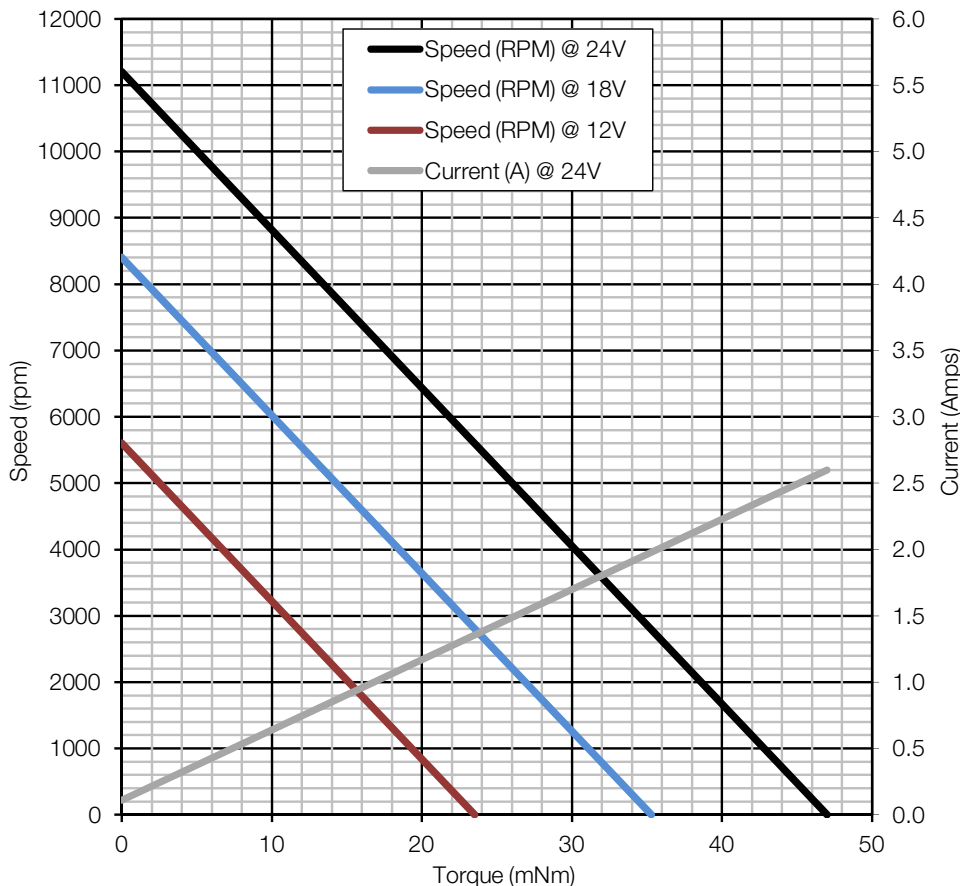

General Specification

Bearings	Sintered
Brushes	Carbon
Rotation	Bi-directional
Number of poles	5
Operating voltage	12 V to 30 V
Nominal resistance	12.5 Ω
Nominal inductance	3.8 mH
Typical detent torque	2.4 mNm
Suppression	None
Weight	72 g

Contact:

www.rotalink.com
 info@rotalink.com
 T: +44 (0)1460 72000
 F: +44 (0)1460 74278

Rotalink Limited
 Cropmead, Crewkerne
 Somerset TA18 7HQ, UK

www.rotalink.com