

Permanent Magnet Stepping Motors

SB2513-048

Issue 03:CN3815

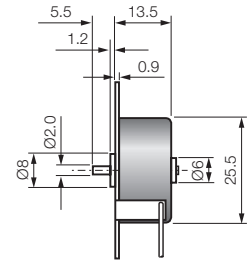
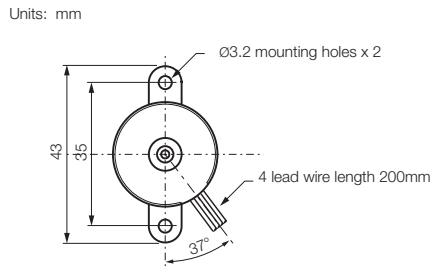

Model Number	Phase voltage (V)	Phase current (A)	Phase resistance (Ω)	Phase inductance (mH)	Winding
SB2513-048-200-24	24	0.12	200	112	Bi-polar

General Specification

Holding torque	15mNm
Step angle	7.5°
Rotor Inertia	0.07 kgm ² x10 ⁻⁶
Temperature rise	110°C
Ambient temp. range	-5°C to +40°C
Weight	28g

Motor options

- Alternative voltage/phase resistance
- Alternative shaft lengths
- Alternative lead lengths
- 10 mm front bearing

Characteristics

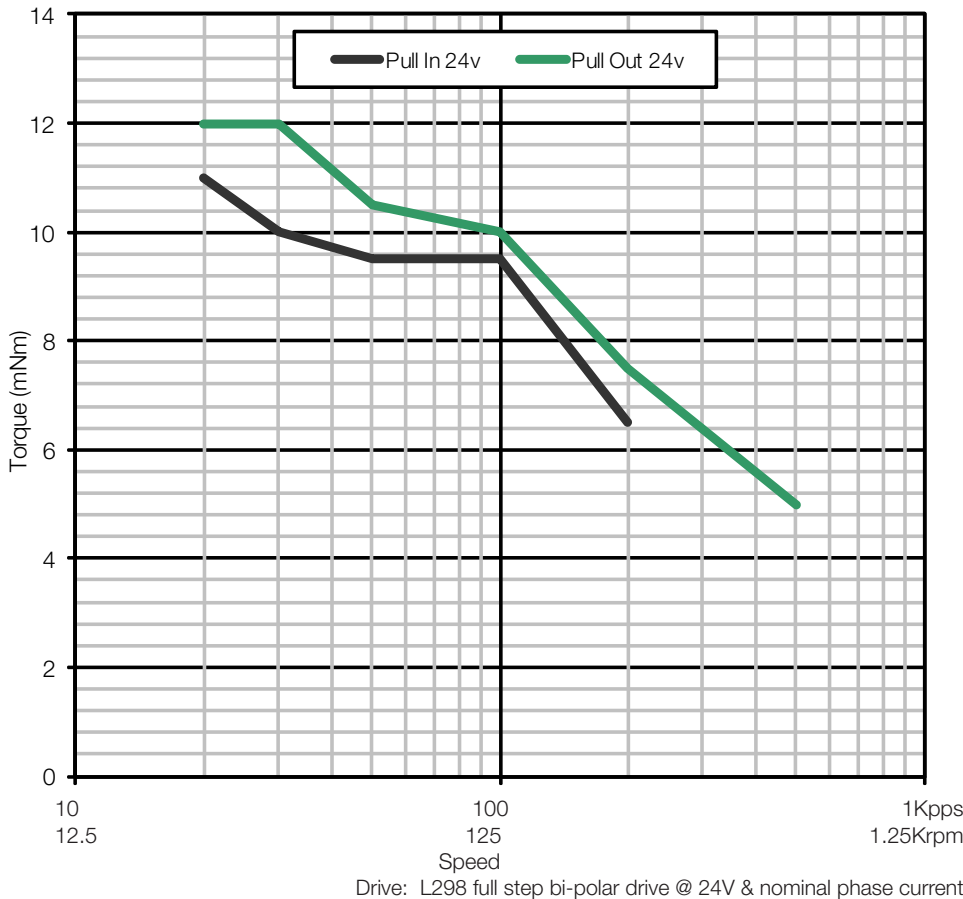

Full step bi-polar sequence

CW dir.	Step 1	Step 2	Step 3	Step 4
Red	-	+	+	-
Yellow	+	-	-	+
Red/Black	+	+	-	-
Yellow/Black	-	-	+	+

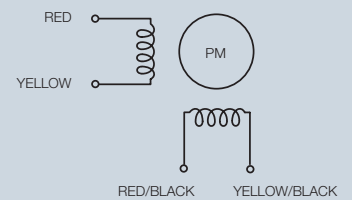

Contact:

www.rotalink.com
info@rotalink.com
 T: +44 (0)1460 72000

Rotalink Limited
 Cropmead, Crewkerne
 Somerset TA18 7HQ, UK

www.rotalink.com