

Gearboxes

Type 223

Spur Ovoid

Issue 08:CN4023



Rotalink

Miniature Motors, Transmission and Control

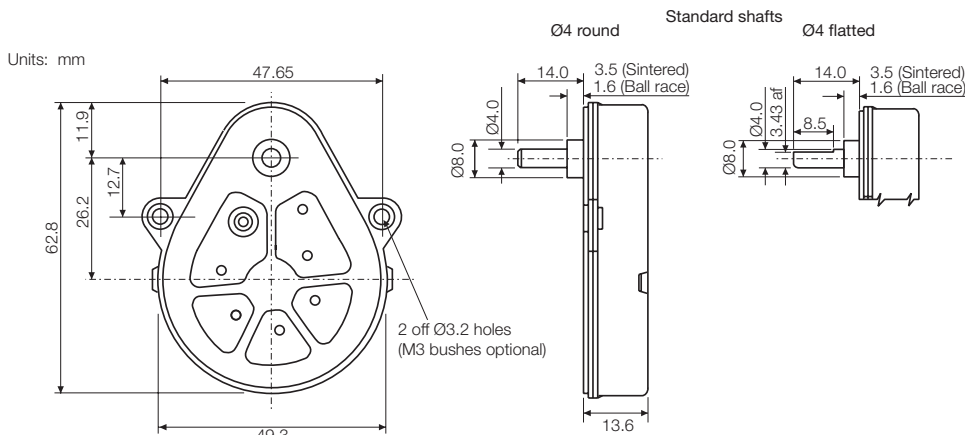

Typical Ratios

20:1	150:1	2000:1
25:1	180:1	3000:1
30:1	200:1	3750:1
100:3	240:1	15000:1
40:1	250:1	18000:1
50:1	300:1	30000:1
60:1	400:1	45000:1
200:3	500:1	90000:1
80:1	600:1	360000:1
250:3	750:1	540000:1
100:1	800:1	720000:1
120:1	1000:1	1080000:1

Characteristics

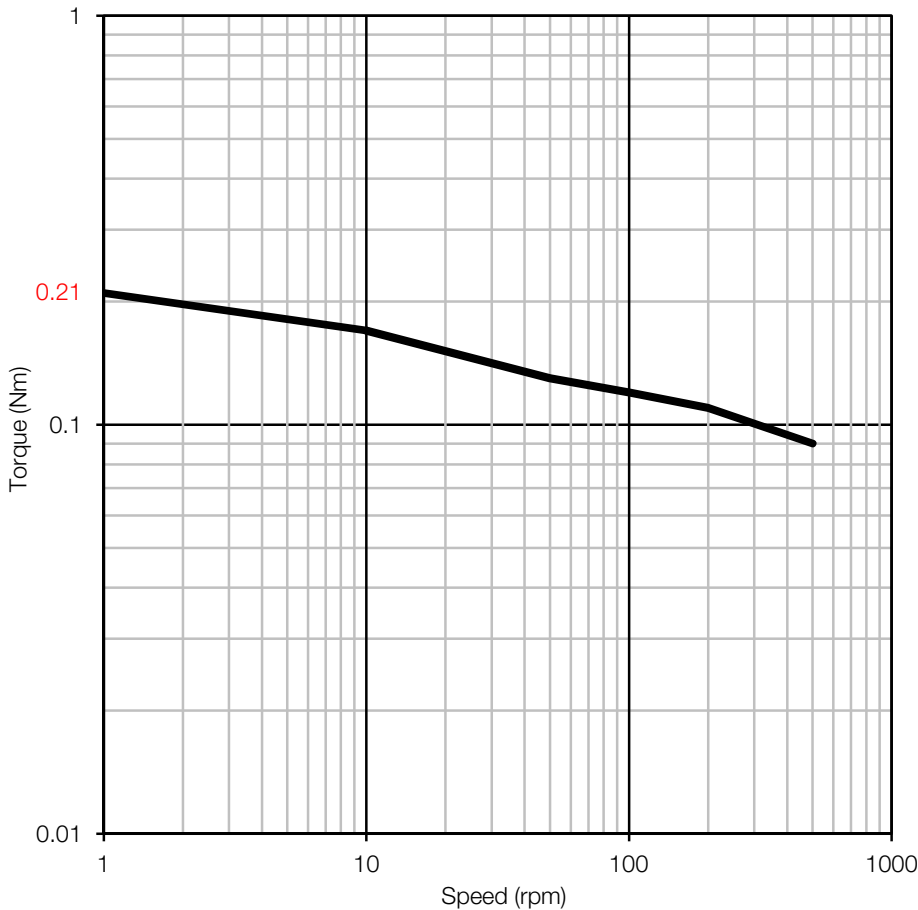

General Specification

Zinc plated pressed steel gearbox case and front cover. Acetal spur gears running on fixed steel spindles. Stainless steel shaft, sintered bronze front and nylon back bearing. Maximum temperature 80°C at the gearcase.

Gearbox Options

Special shafts
Ball race bearings
M3 threaded eyelets - Min bulkhead thickness for countersunk screws, 2mm

Contact:

www.rotalink.com
info@rotalink.com
T: +44 (0)1460 72000

Rotalink Limited
Cropmead, Crewkerne
Somerset TA18 7HQ, UK

www.rotalink.com