

Gearboxes

Type RG30

Spur In-line

Issue 06:CN3262

Units: mm

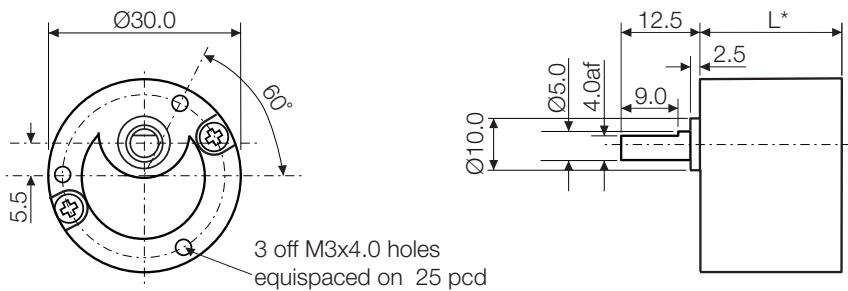

Typical Ratios

30:1	250:1
50:1	500:1
75:1	810:1
100:1	1000:1
180:1	

L^* (Lengths dependant on gear ratio)
 30:1 - 100:1 - 23.0 mm
 180:1 - 1000:1 - 28.0 mm

Characteristics

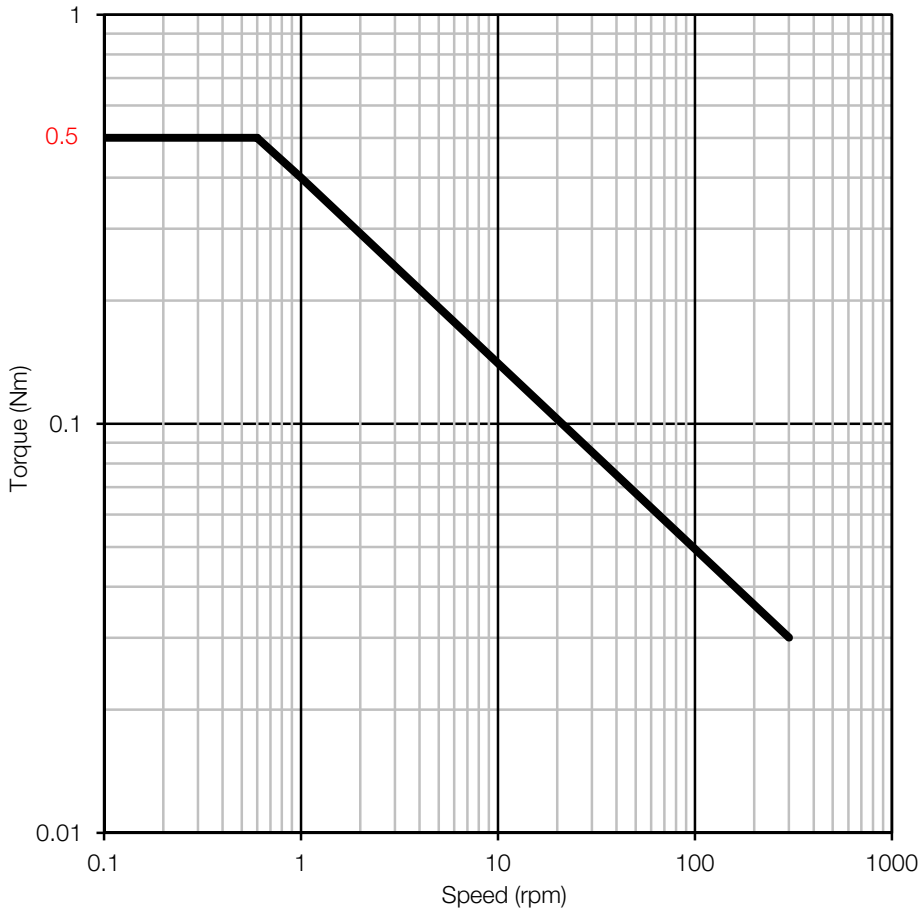

General Specification

Die cast cover enclosing steel end plate with 3 point equispaced fixing. Steel spur gears running on fixed spindles. Steel drive shaft with sintered steel bearings. Temperature range, -10 to 60°C at the gearcase.

Gearbox Options

Moulded first gear: RG30P

Contact:

www.rotalink.com
info@rotalink.com
 T: +44 (0)1460 72000
 F: +44 (0)1460 74278

Rotalink Limited
 Cropmead, Crewkerne
 Somerset TA18 7HQ, UK

www.rotalink.com