

Gearboxes

Type PG42

Issue 04



Rotalink
Miniature Motors, Transmission and Control

Units: mm

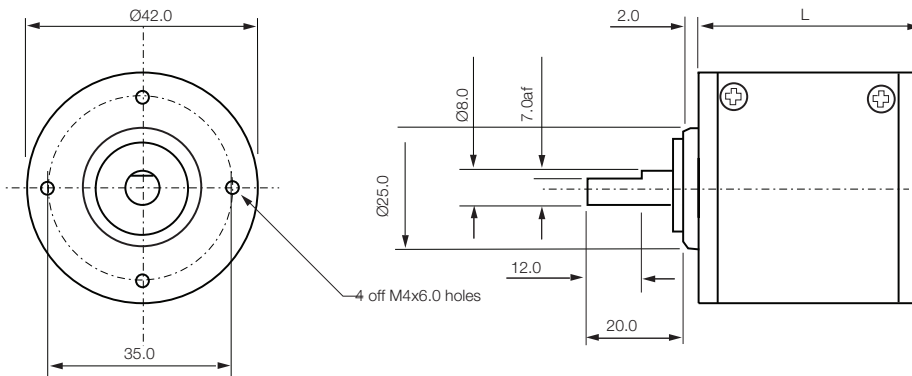

Typical Ratios

14:1 (14:1)	- 'L' 39.2 mm
24:1 (24:1)	- 'L' 39.2 mm
49:1 (49:1)	- 'L' 45.9 mm
84:1 (84:1)	- 'L' 45.9 mm
104:1 (104:1)	- 'L' 45.9 mm
144:1 (144:1)	- 'L' 45.9 mm
212:1 (637:3)	- 'L' 52.6 mm
294:1 (294:1)	- 'L' 52.6 mm
504:1 (504:1)	- 'L' 52.6 mm
720:1 (720:1)	- 'L' 52.6 mm
1062:1 (3185:3)	- 'L' 59.3 mm
1470:1 (1470:1)	- 'L' 59.3 mm

Characteristics

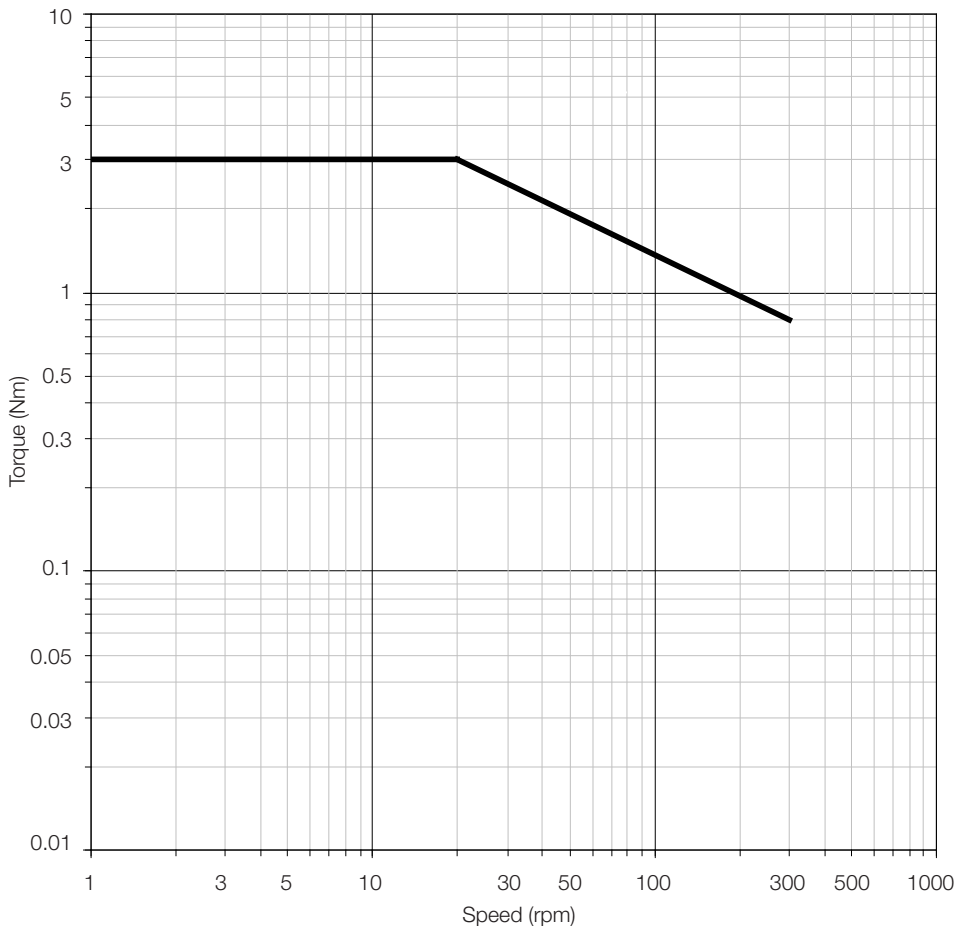

General Specification

Aluminium outer casing with die cast end plate. 4 point equispaced fixing. Steel planetary gears, stainless steel shaft with ball race bearings. Temperature range, -10 to 60°C at the gearcase.

Gearbox Options

Wide range of alternative ratios

Contact:

www.rotalink.com
info@rotalink.com
 T: +44 (0)1460 72000
 F: +44 (0)1460 74278

Rotalink Limited
 Cropmead, Crewkerne
 Somerset TA18 7HQ, UK

www.rotalink.com