

DC Motors

D2431-13260

Issue 07:CN3815

Unit: mm

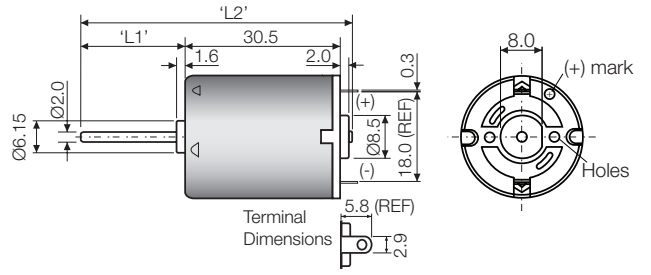
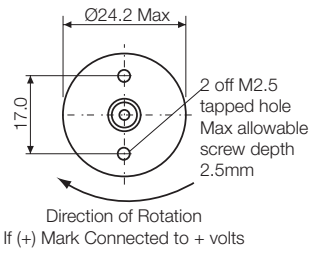

Model Number	Performance									
	Volts V	No Load		Maximum Efficiency				Stall		Max Power W
		Speed rpm	Current A	Speed rpm	Current A	Torque mNm	Output W	Torque mNm	Current A	
D2431-13260	12	7600	0.08	6234	0.27	3.0	2.0	16.7	2.1	3.3

Performance characteristics and general specification are from calculated data.

Characteristics

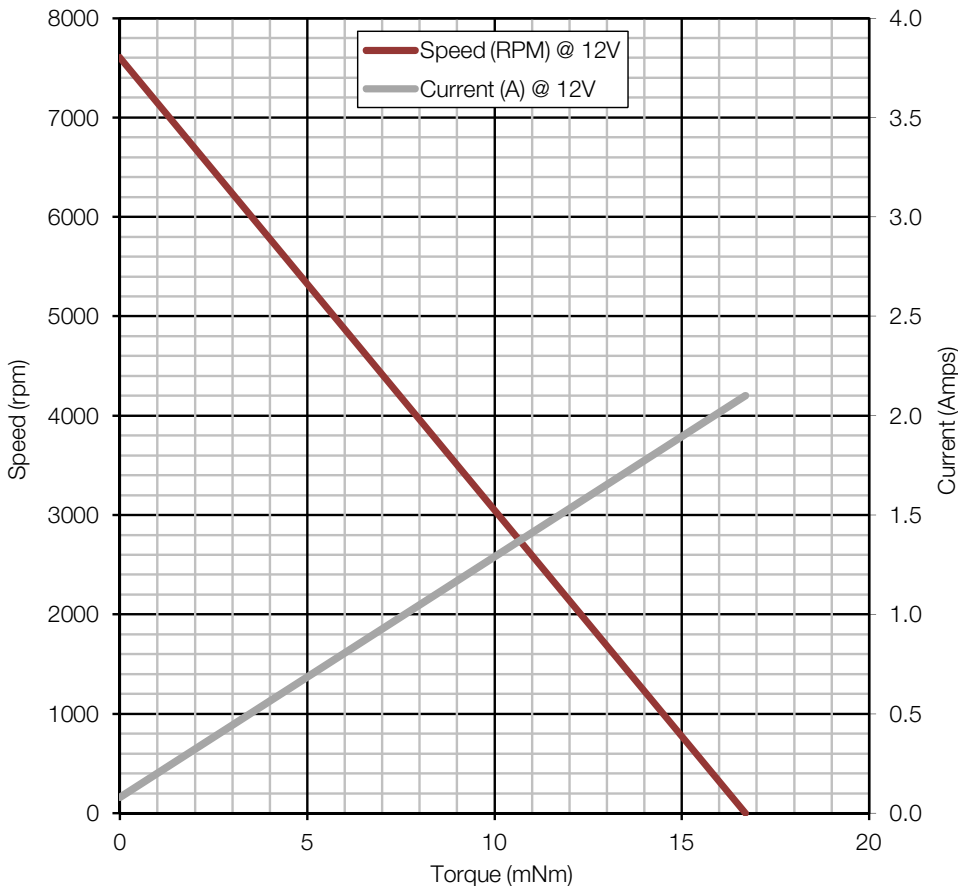

General Specification

- Bearings: Sintered
- Brushes: Carbon
- Rotation: Bi-directional
- Number of poles: 3
- Operating voltage: 6 V to 15 V
- Nominal resistance: 14.3 Ω
- Nominal inductance: 4.5 mH
- Typical detent torque: 1 mNm
- Suppression: Internal ring varistor
- Weight: 45 g
- Shaft length options 'L1', 'L2':
 - D2431-13260: 20.7mm, 55.0 mm
 - D2431-13260S: 12.0mm, 45.0 mm

Contact:

www.rotalink.com
 info@rotalink.com
 T: +44 (0)1460 72000

Rotalink Limited
 Cropmead, Crewkerne
 Somerset TA18 7HQ, UK

www.rotalink.com