

# Permanent Magnet Stepping Motors

S3522

Issue 03:CN5428

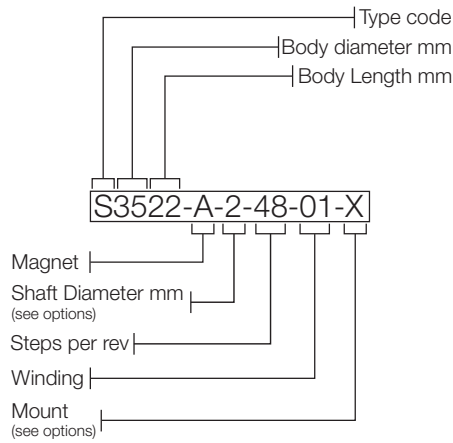

# Rotalink

Miniature Motors, Transmission and Control

Model Number	Phase voltage (V)	Phase current (A)	Phase resistance (Ω)	Phase inductance @ 50Hz (mH)	Winding
S3522-A2-48-01X	10	0.12	87	165	Bipolar

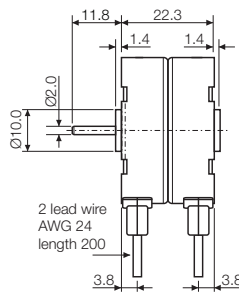
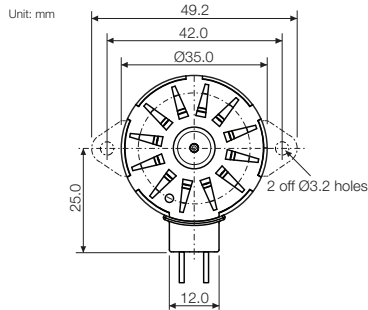

## General Specification

Holding torque	21mNm
Step angle	7.5°
Rotor Inertia	0.5 kgm <sup>2</sup> x10 <sup>-6</sup>
Temperature rise	60°C
Ambient temp. range	-5°C to +50°C
Dielectric strength	500V AC 1sec
Weight	80g

## Motor options

Shaft Diameter (ØD) - 2mm  
Mount - Clip (C), Adaptor Plate (S)

Alternative voltage/phase resistance  
Alternative lead lengths

## Characteristics

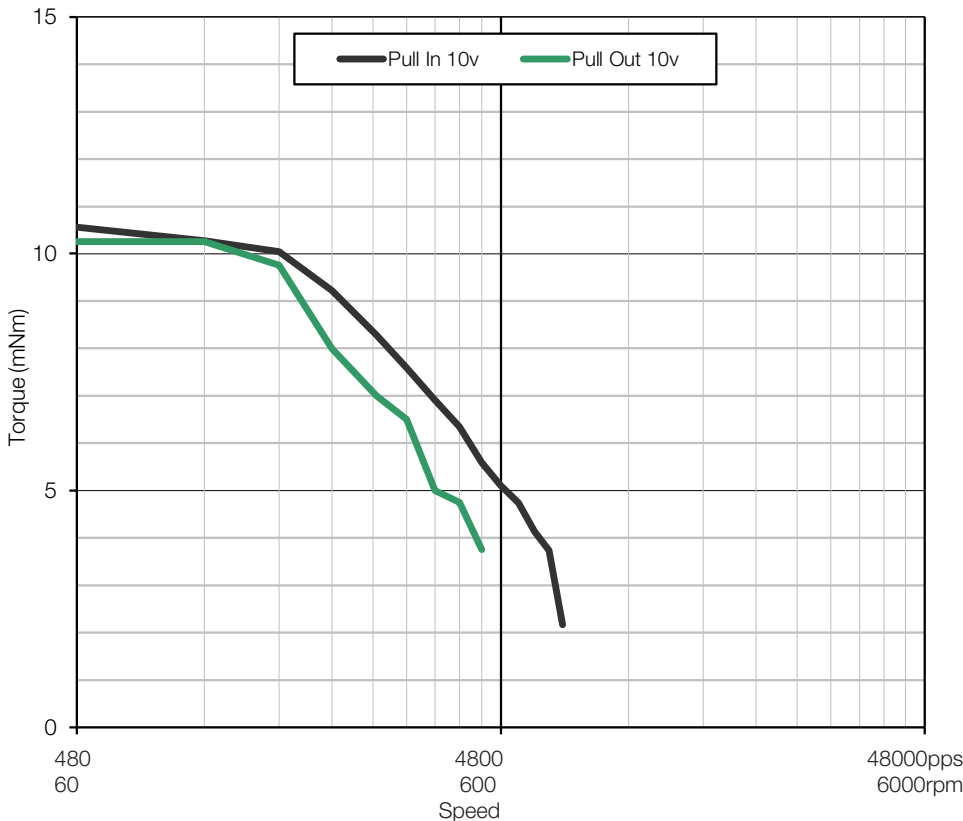

Drive: Microstep/full step morphing chopper drive @ 30V & phase current  
Load Inertia: 9.54 x 10<sup>-7</sup> kgm<sup>2</sup>

## Full step bipolar sequence

CW dir.	Step 1	Step 2	Step 3	Step 4
Black	-	+	+	-
Red	+	-	-	+
White	+	+	-	-
Blue	-	-	+	+

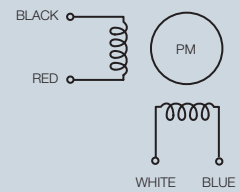

Contact:  
www.rotalink.com  
info@rotalink.com  
T: +44 (0)1460 72000

Rotalink Limited  
Cropmead, Crewkerne  
Somerset TA18 7HQ, UK

www.rotalink.com

This drawing and any information, descriptions and know how contained hereon (altogether "the drawing") are confidential and are the sole property of Rotalink Limited. Rotalink Limited owns all copyright, design right and all other intellectual property in the drawing and neither the drawing nor any part of it may be disclosed, loaned, copied, used for manufacturing or in relation to tenders or used for any other purpose without the express written permission of Rotalink Limited.

The contents of this data sheet are intended as reference material not product specification and are subject to alteration without prior notice. Please contact our sales team for detailed information.